

THE SHOPPES ON BROADWAY - PAD SITE

3224 S BROADWAY, EDMOND, OK 73013



## PROPERTY DESCRIPTION

Pad C is available For Ground Lease or Build To Suit or For Sale | 1.22 Acres

Located in the heart of Edmond at the intersection of 33rd Street & Broadway, this upscale center is a shopping destination with premier Tenants.

Edmond's finest mixed use development; premier retail space.

## OFFERING SUMMARY

<b>Sale Price:</b>	Subject To Offer
<b>Lease Rate:</b>	Negotiable
<b>Available SF:</b>	53,214 SF
<b>Building Size:</b>	125,295 SF
	07292024

DEMOGRAPHICS	1 MILE	3 MILES	5 MILES
<b>Total Households</b>	3,536	23,720	50,608
<b>Total Population</b>	9,798	61,630	130,051
<b>Average HH Income</b>	\$62,392	\$70,774	\$80,061

### EV ERNST

ernst@priceedwards.com  
O: 405.843.7474

### GEORGE WILLIAMS, CCIM

gwilliams@priceedwards.com  
O: 405.239.1270 C: 405.657.7800

### JACOB SIMON

jsimon@priceedwards.com  
O: 405.239.1248

# PRICE EDWARDS AND CO. FOR SALE | GROUND LEASE

THE SHOPPES ON BROADWAY - PAD SITE

3224 S BROADWAY, EDMOND, OK 73013

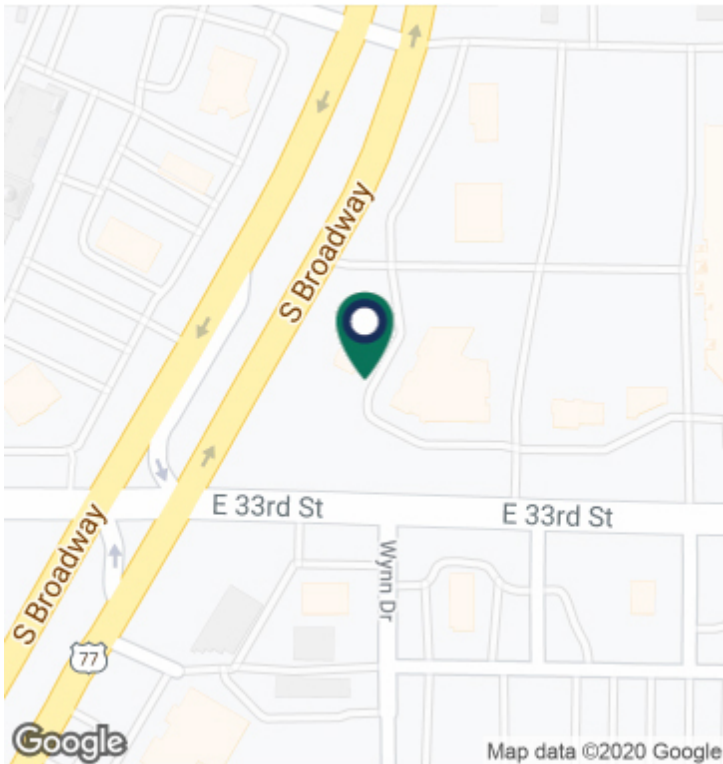
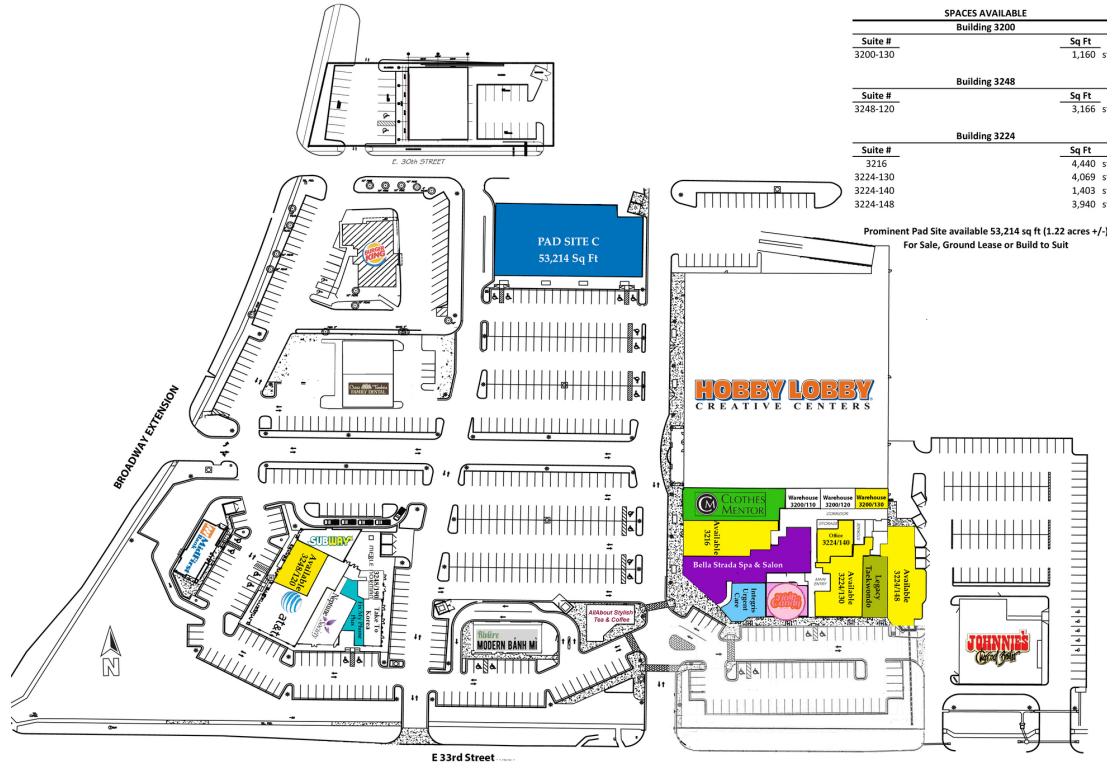

**EV ERNST**

ernst@priceedwards.com  
O: 405.843.7474

**GEORGE WILLIAMS, CCIM**

gwilliams@priceedwards.com  
O: 405.239.1270 C: 405.657.7800

**JACOB SIMON**

jsimon@priceedwards.com  
O: 405.239.1248