

PRICE
EDWARDS
AND COMPANY

154.38 ± Acre Land Parcel
FOR SALE

5204 S. MUSTANG RD, MUSTANG, OK 73064

\$4,900,000

- CONNECTS TO I-40, STATE HWY 152 AND KILPATRICK TURNPIKE
- MINUTES TO WILL ROGERS WORLD AIRPORT
- LOCAL MARKET IS IN AN EXPANSION PHASE FOR NEW RESIDENTIAL CONSTRUCTION
- ZONING: AGRICULTURAL



EV ERNST

405.843.7474
ernst@priceedwards.com



AARON DIEHL

405.843.7474 X255
adiehl@priceedwards.com

PE
AND
CO.

5204 S. MUSTANG ROAD

154.38 Acre Land Parcel

Mustang, Oklahoma

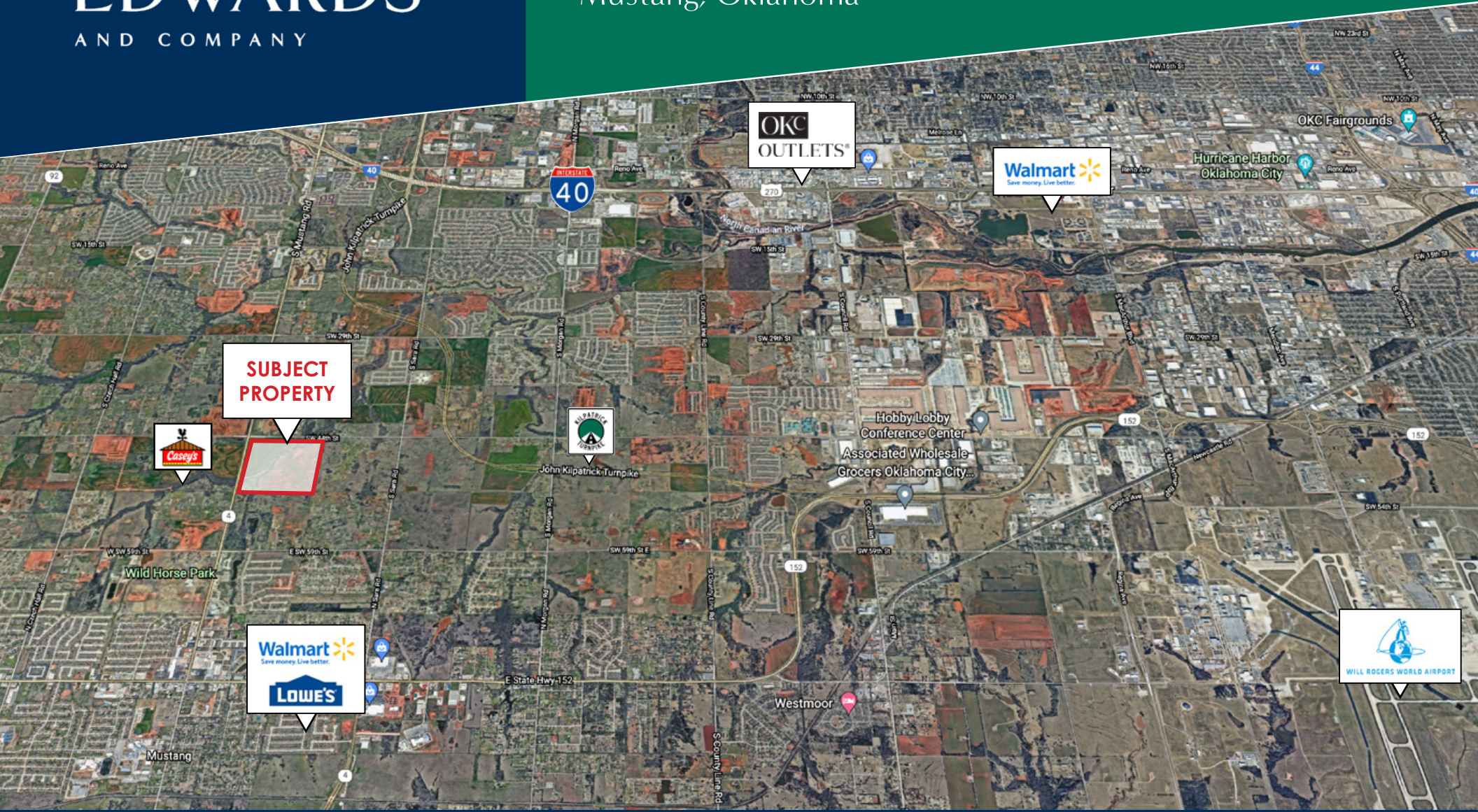

MUSTANG, OK

Development Area Demographics

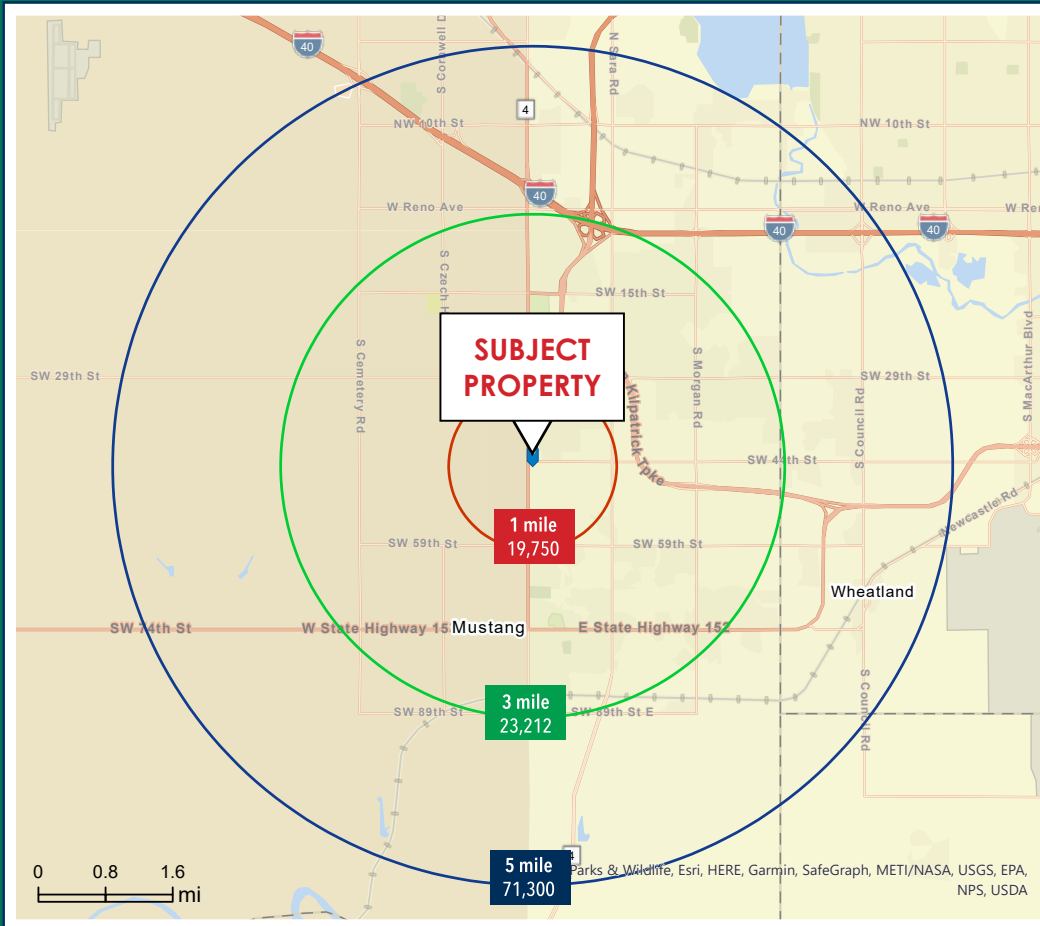

HOUSING

Median home value is displayed for markets that are primarily owner occupied; average rent is shown for renter-occupied markets. Tenure and home value are estimated by Esri. Housing type and average rent are from the Census Bureau's American Community Survey.



Typical Housing:
Single Family

Median Value:
\$235,500

US Median: \$207,300

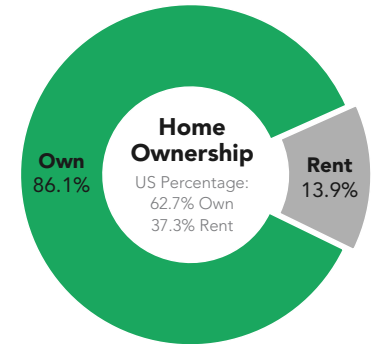

INCOME AND NET WORTH

Net worth measures total household assets (homes, vehicles, investments, etc.) less any debts, secured (e.g., mortgages) or unsecured (credit cards). Household income and net worth are estimated by Esri.

Median Household Income

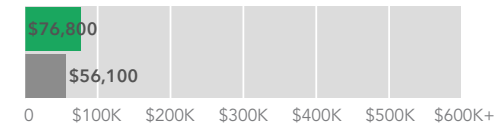

Median Net Worth

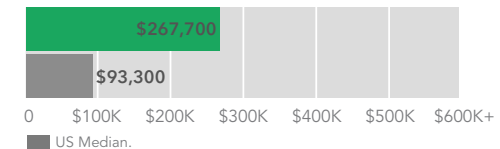

Demographic information obtained from ESRI.com and US Census Bureau

DEMOGRAPHICS 1 & 3 Mile Radius [per 2021 Census]

Total Population

2,027 47,539
1 Mile 3 Mile

Average Age

36 34
1 Mile 3 Mile

Average HH Income

\$105,159 \$98,437
1 Mile 3 Mile

of Persons per HH

2.5 2.6
1 Mile 3 Mile

Total Housing Units

2,046 17,015
1 Mile 3 Mile

Total Households

810 17,575
1 Mile 3 Mile