

THE SHOPPES ON BROADWAY - PAD SITE

3224 S BROADWAY, EDMOND, OK 73013



PROPERTY DESCRIPTION

Pad C is available For Ground Lease or Build To Suit or For Sale | 1.22 Acres

Located in the heart of Edmond at the intersection of 33rd Street & Broadway, this upscale center is a shopping destination with premier Tenants.

Edmond's finest mixed use development; premier retail space.

OFFERING SUMMARY

| | |
|-----------------------|------------------|
| Sale Price: | Subject To Offer |
| Lease Rate: | Negotiable |
| Available SF: | 53,214 SF |
| Building Size: | 125,295 SF |
| | 05032024 |

| DEMOGRAPHICS | 1 MILE | 3 MILES | 5 MILES |
|--------------------------|----------|----------|----------|
| Total Households | 3,536 | 23,720 | 50,608 |
| Total Population | 9,798 | 61,630 | 130,051 |
| Average HH Income | \$62,392 | \$70,774 | \$80,061 |

EV ERNST

ernst@priceedwards.com
O: 405.843.7474

GEORGE WILLIAMS, CCIM

gwilliams@priceedwards.com
O: 405.239.1270 C: 405.657.7800

JACOB SIMON

jsimon@priceedwards.com
O: 405.239.1248

PRICE EDWARDS AND CO. FOR SALE | GROUND LEASE

THE SHOPPES ON BROADWAY - PAD SITE

3224 S BROADWAY, EDMOND, OK 73013

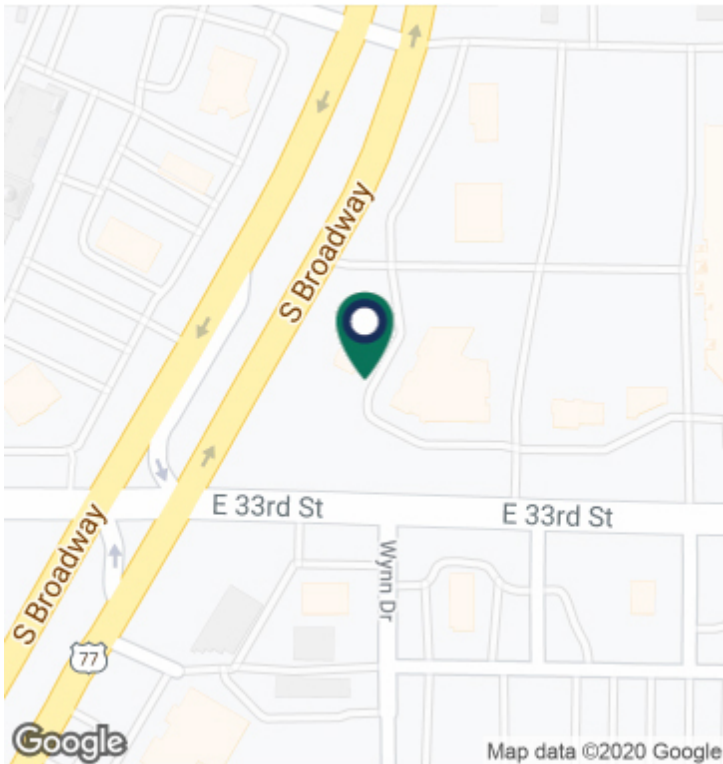
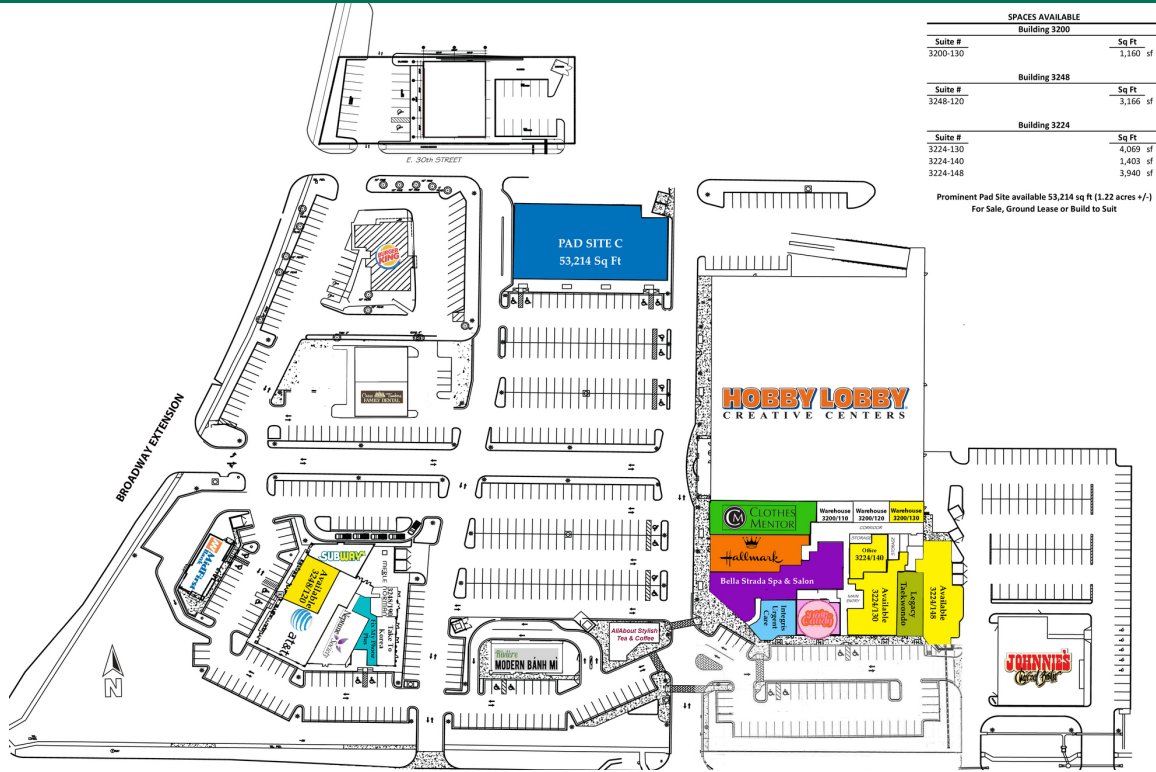

EV ERNST

ernst@priceedwards.com
O: 405.843.7474

GEORGE WILLIAMS, CCIM

gwilliams@priceedwards.com
O: 405.239.1270 C: 405.657.7800

JACOB SIMON

jsimon@priceedwards.com
O: 405.239.1248