

PRIME RETAIL SPACE ADJACENT TO KOHL'S

Midwest City, OK 73110 | 7401 SE 29th St | SE 29th & S Midwest Blvd | #114

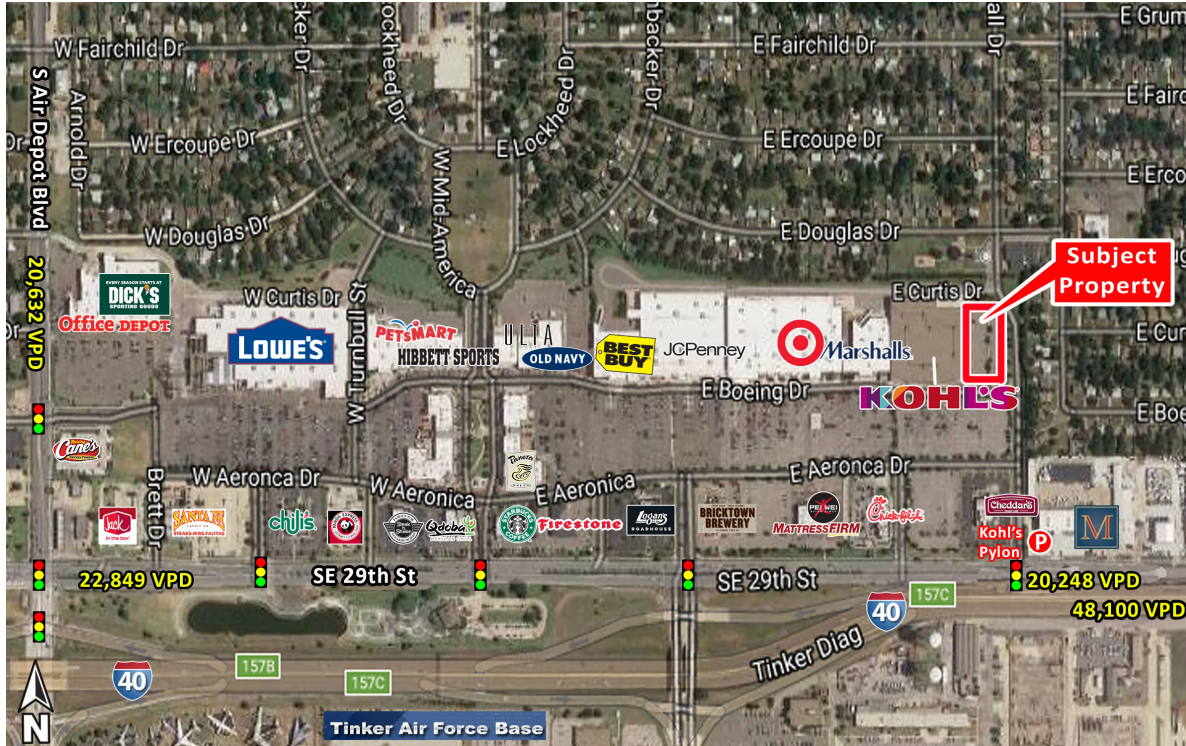

AVAILABLE SF:
24,500 SF

FRONTAGE:
APPROXIMATELY 97'6"

ZONING:
COMMERCIAL

RATES:
CALL FOR DETAILS

- 24,500 +/- sf space available adjacent to Kohl's.
- Located off SE 29th Street, facing Interstate 40 and across from Tinker Air Force Base



DEMOGRAPHICS	1 MILE	3 MILES	5 MILES	TRAFFIC COUNTS		
2018 POPULATION	4,910	59,645	118,324	SE 29th	east	20,248 VPD
2018 DAYTIME POPULATION	6,044	66,995	116,314	SE 29th	west	22,849 VPD
2018 AVERAGE HH INCOME	\$ 50,500	\$ 59,049	\$ 59,286	S Air Depot	north	20,632 VPD
2018 MEDIAN HH INCOME	\$ 38,996	\$ 46,556	\$ 46,861	Interstate 40	east/west	48,100 VPD



FOR MORE INFORMATION, CONTACT EXCLUSIVE ASSOCIATE:
 KARLEEN KRYWUCKI . kkrywucki@pricedwards.com . 405.239.1243

Demographics ESRI 2018 No warranty expressed or implied has been made as to the accuracy of the information provided herein, no liability assumed for error or omissions.



PRIME RETAIL SPACE ADJACENT TO KOHL'S

Midwest City, OK 73110 | 7401 SE 29th St | SE 29th & S Midwest Blvd | #114



FOR MORE INFORMATION, CONTACT EXCLUSIVE ASSOCIATE:
KARLEEN KRYWUCKI . kkrywucki@priceedwards.com . 405.239.1243



Demographics ESRI 2018 No warranty expressed or implied has been made as to the accuracy of the information provided herein, no liability assumed for error or omissions.

PRIME RETAIL SPACE ADJACENT TO KOHL'S

Midwest City, OK 73110 | 7401 SE 29th St | SE 29th & S Midwest Blvd | #114



FOR MORE INFORMATION, CONTACT EXCLUSIVE ASSOCIATE:
KARLEEN KRYWUCKI . kkrywucki@pricedwards.com . 405.239.1243



CHAINLINKS
RETAIL ADVISORS

Demographics ESRI 2018 No warranty expressed or implied has been made as to the accuracy of the information provided herein, no liability assumed for error or omissions.

PRIME RETAIL SPACE ADJACENT TO KOHL'S

Midwest City, OK 73110 | 7401 SE 29th St | SE 29th & S Midwest Blvd | #114

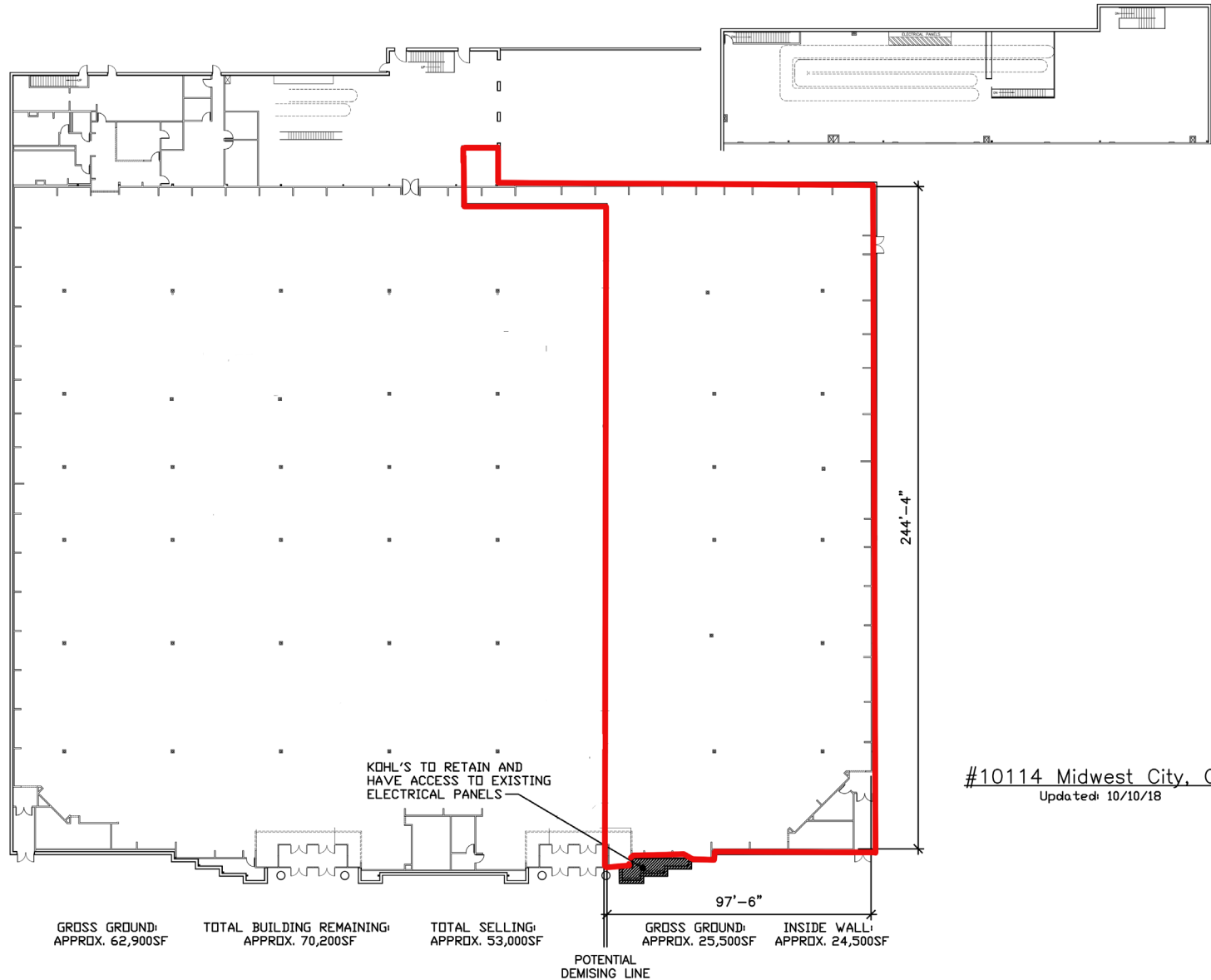

#10114 Midwest City, OK
Updated: 10/10/18



FOR MORE INFORMATION, CONTACT EXCLUSIVE ASSOCIATE:
KARLEEN KRYWUCKI . kkrywucki@pricedwards.com . 405.239.1243



Demographics ESRI 2018 No warranty expressed or implied has been made as to the accuracy of the information provided herein, no liability assumed for error or omissions.