

200 NE 12TH ST

MOORE, OK 73160

INDUSTRIAL SPACE AVAILABLE FOR LEASE

200 NE. 12th Street | Moore, OK 73160



PROPERTY DESCRIPTION

This 25,000 SF property features six dock-high bays and ten spacious overhead doors (14x12). It has approximately 3,000 SF of office space, all housed in a concrete structure. The property also includes a securely fenced area, offering both convenience & security for your operations.

LOCATION DESCRIPTION

Situated in a strategic location right off I-35 and 12th Street in Moore.

PROPERTY HIGHLIGHTS

- 6 Dock High 10x10
- 10 Overhead Doors 14x12
- Fenced In Area
- Solid Concrete Construction

OFFERING SUMMARY

Lease Rate:	\$7.75 SF/yr (NNN)
Available SF:	± 25,000 SF
	Divisible by 6,000 SF

DEMOGRAPHICS

	1 MILE	3 MILES	5 MILES
Total Households	4,658	30,671	59,049
Total Population	12,030	78,280	154,751
Average HH Income	\$80,033	\$83,261	\$86,237

MONICA WITROCK

mwitrock@priceedwards.com
O: 405.843.7474

CHRIS ROBERTS

croberts@priceedwards.com
O: 405.239.1236

200 NE 12TH ST

MOORE, OK 73160

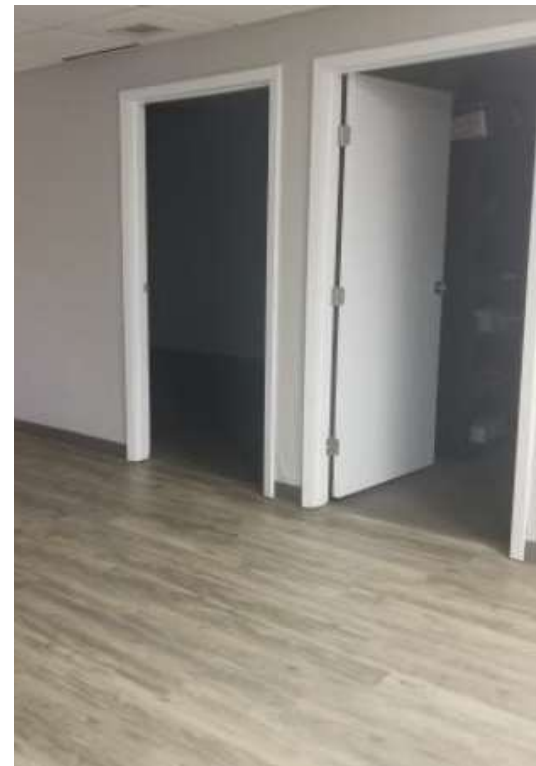

MONICA WITROCK

mwitrock@priceedwards.com
O: 405.843.7474

CHRIS ROBERTS

croberts@priceedwards.com
O: 405.239.1236

200 NE 12TH ST

MOORE, OK 73160

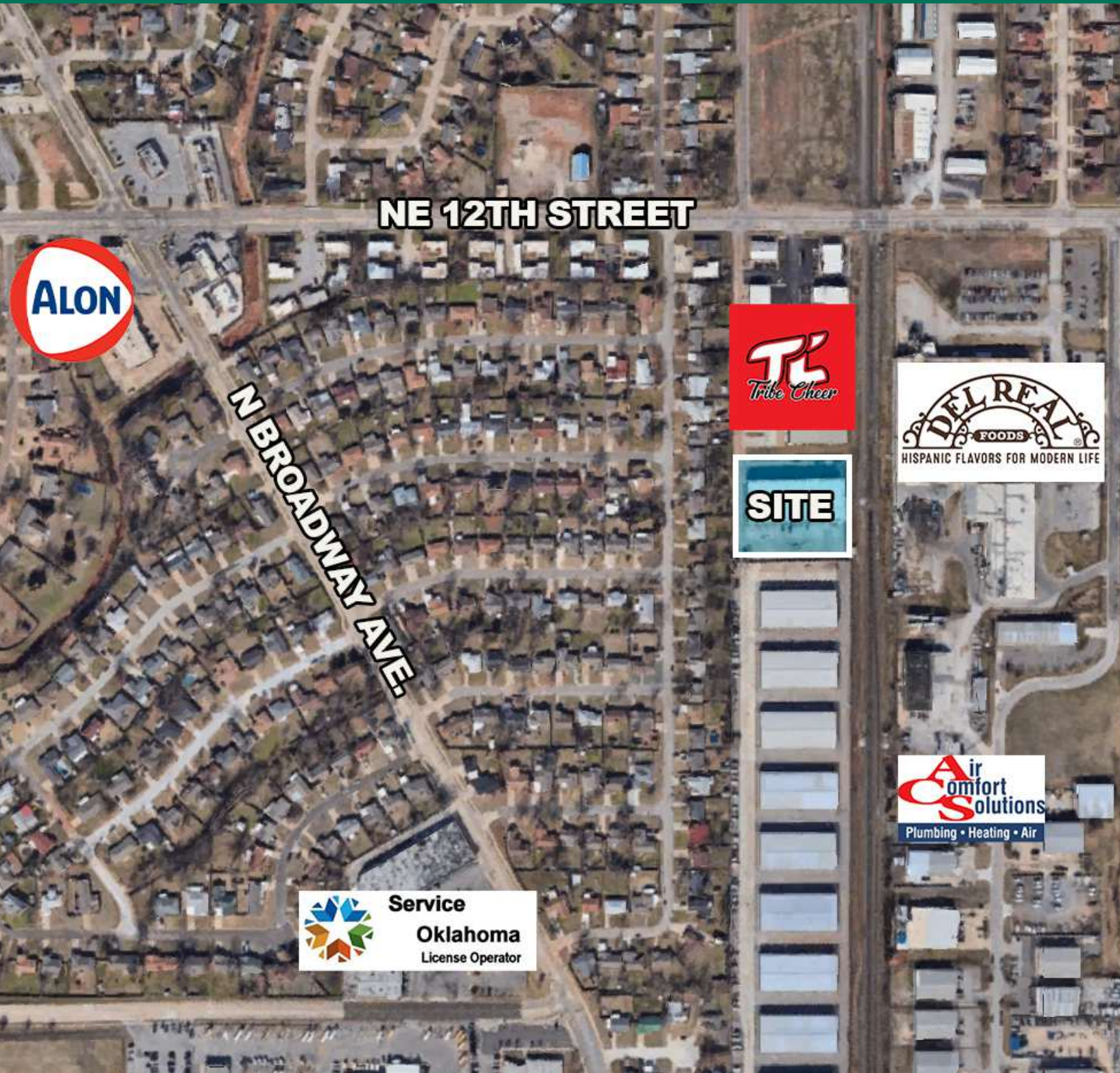

MONICA WITROCK

mwitrock@priceedwards.com

O: 405.843.7474

CHRIS ROBERTS

croberts@priceedwards.com

O: 405.239.1236

200 NE 12TH ST

MOORE, OK 73160



MONICA WITROCK

mwitrock@priceedwards.com

O: 405.843.7474

CHRIS ROBERTS

croberts@priceedwards.com

O: 405.239.1236